

# X-WING

## BUILDING INSTRUCTIONS

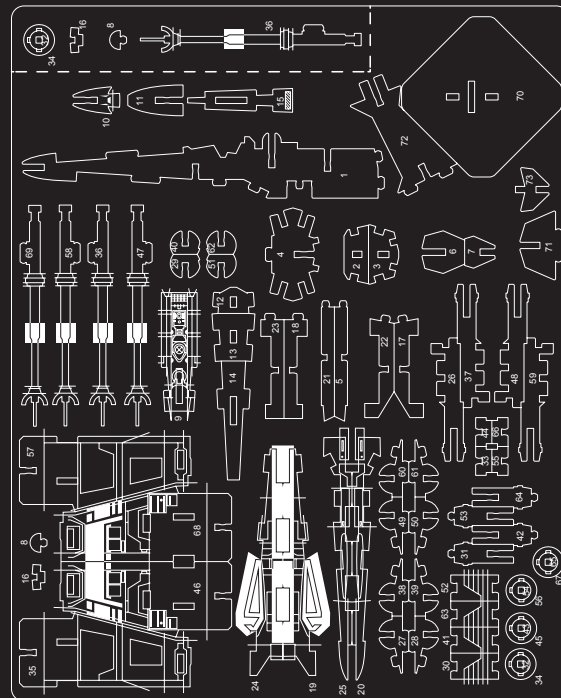

Manufactured in Shaoguan, China 12102016

TM & © 2016 LFL

### READ BEFORE ASSEMBLING:

- Go through the instructions one step at a time.
- Don't punch out all of the pre-cut parts at once.
- Plywood thickness and color may vary.
- While not necessary, glue may be applied if desired.
- Adult supervision recommended.

**!** WARNING: CHOKING HAZARD -  
CONTAINS SMALL PARTS.  
NOT FOR CHILDREN UNDER 3 YRS.

1

Match the board pieces to the numbers on the board image above to find your first two pieces.

2

Pop out only these puzzle pieces from the board.

3

To put the two pieces together, match up the slots on each piece. Slide together.

4

Continue assembling by putting pieces together in numerical order.

5

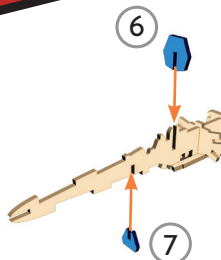

6

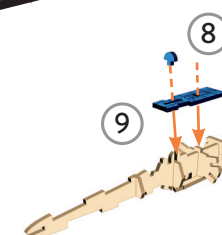

7

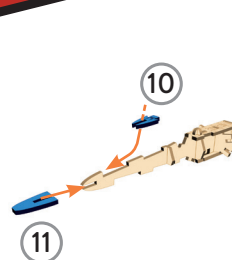

8

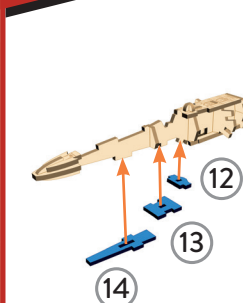

9

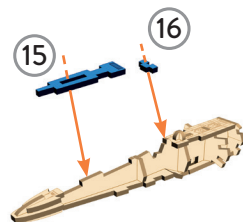

10

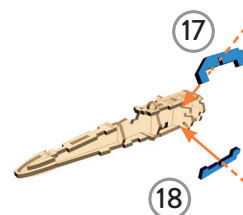

11

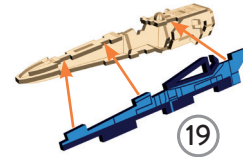

12

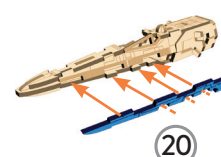

17

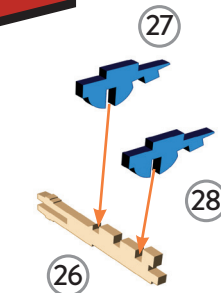

18

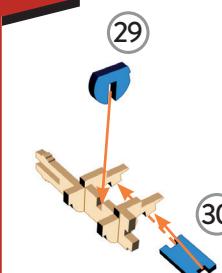

19

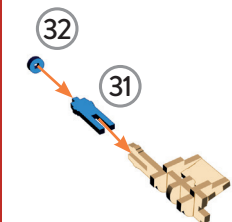

20

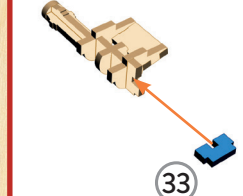

13

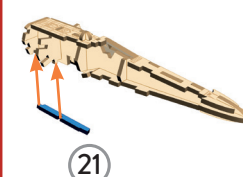

14

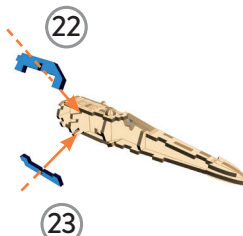

15

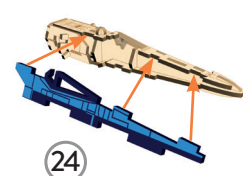

16

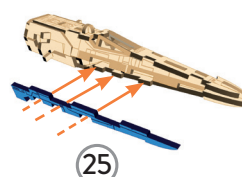

21

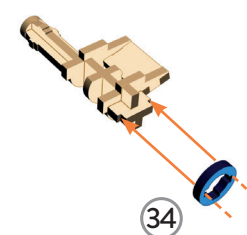

22

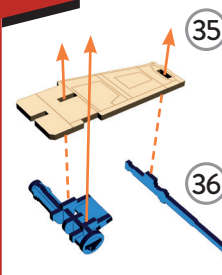

23

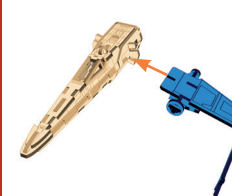

24

